

KOMODA

50

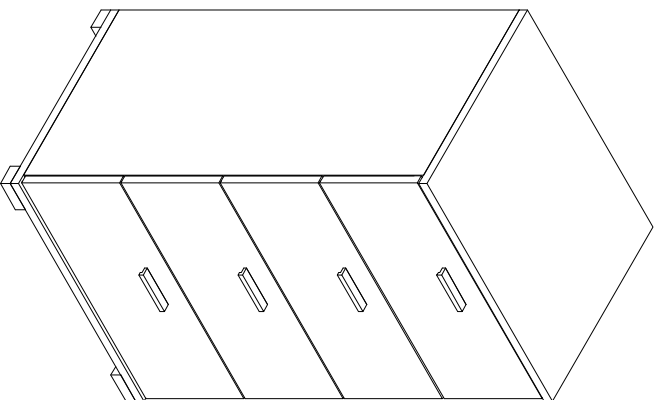

9.6.2017

- D** Montageanleitung
- FR** Notice de montage
- NL** Handleiding voor de montage
- CZ** Montážní návod
- HU** Szerelési útmutató
- TR** Montaj talimatı
- GB** Assembly Instructions
- IT** Istruzioni di montaggio
- PL** Instrukcja montażu
- SK** Návod na montáž
- RO** Instrucțiunile de montaj
- RU** Инструкции по монтажу

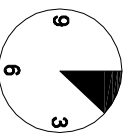

20 min.

1

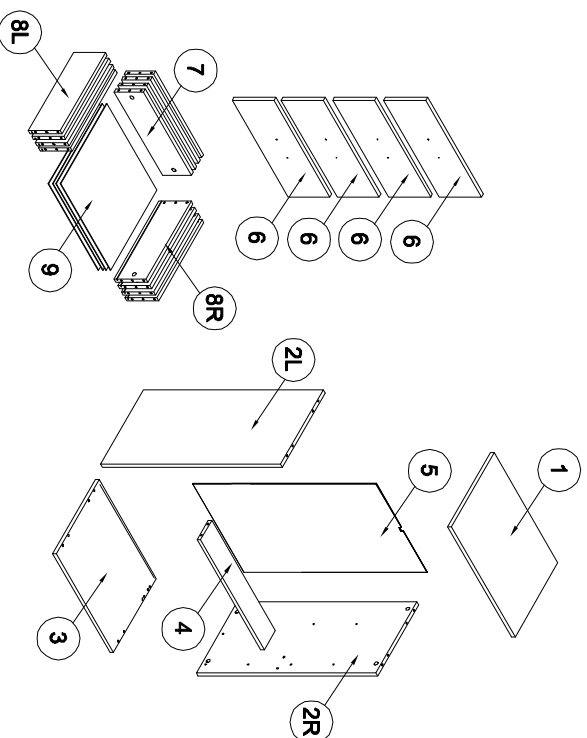

ND 3,5x16 X24	RPS X4	NB 3,5x13 X24	TB X1	TA X1	NA 4x13 X1	C X24	Z X24	GLUE X1
B X24	A 6x32 X44	Y X4	X X6	YA 4x27 X8	W X4	N 3x20 X16	RPS X4	

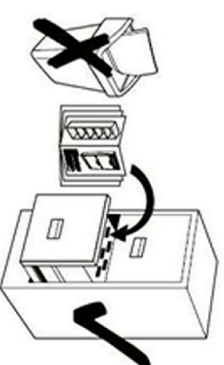
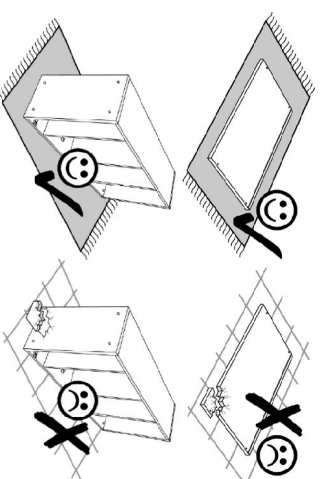

2

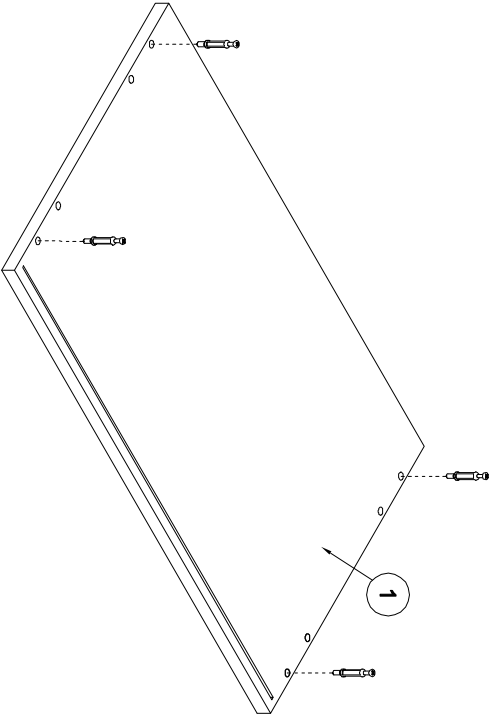
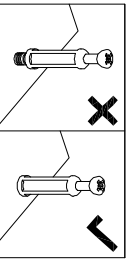

3

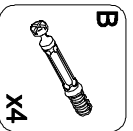
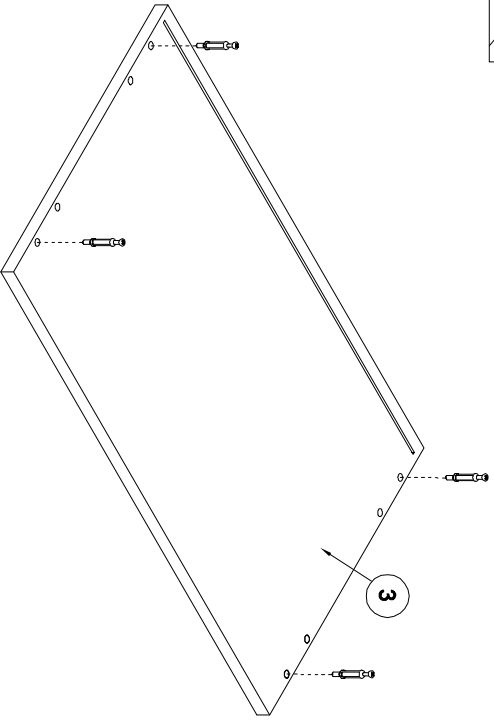
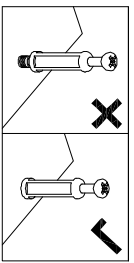

4

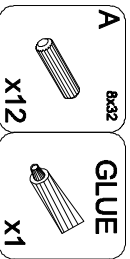
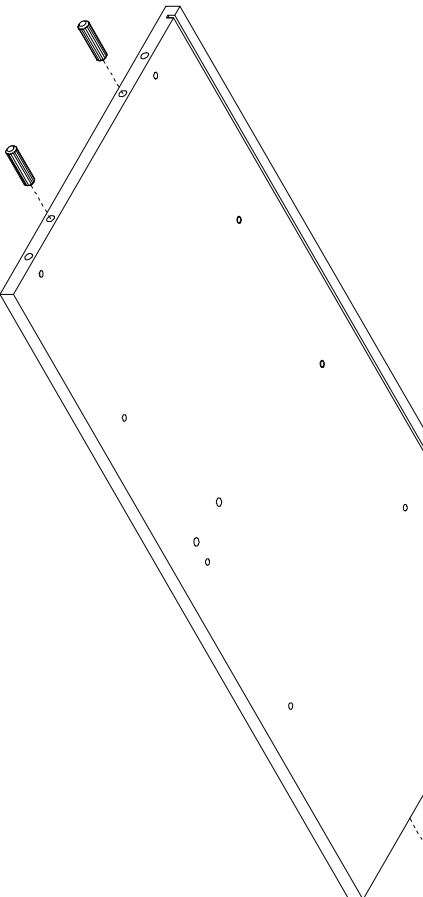
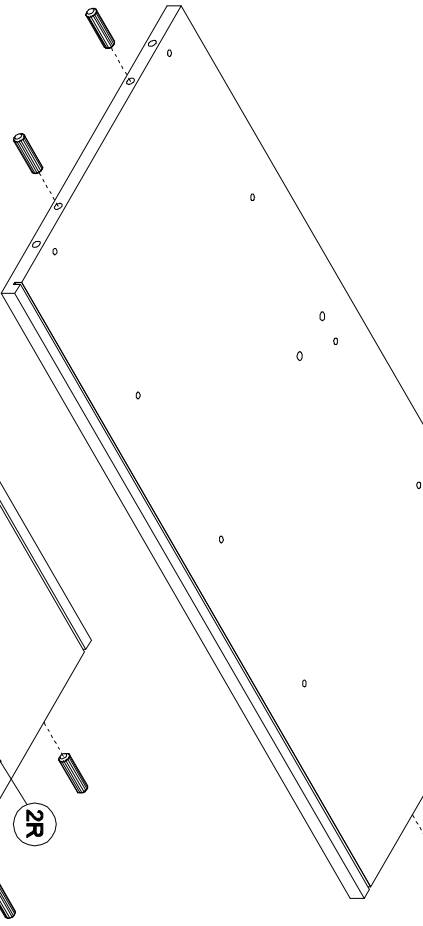
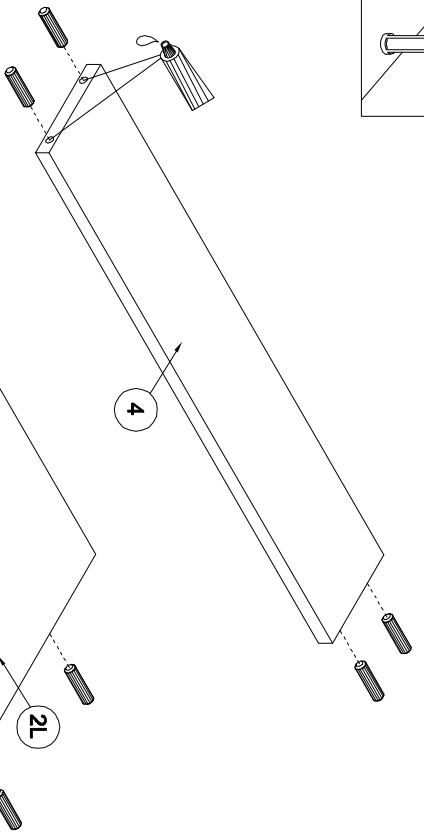
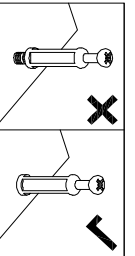

5

6

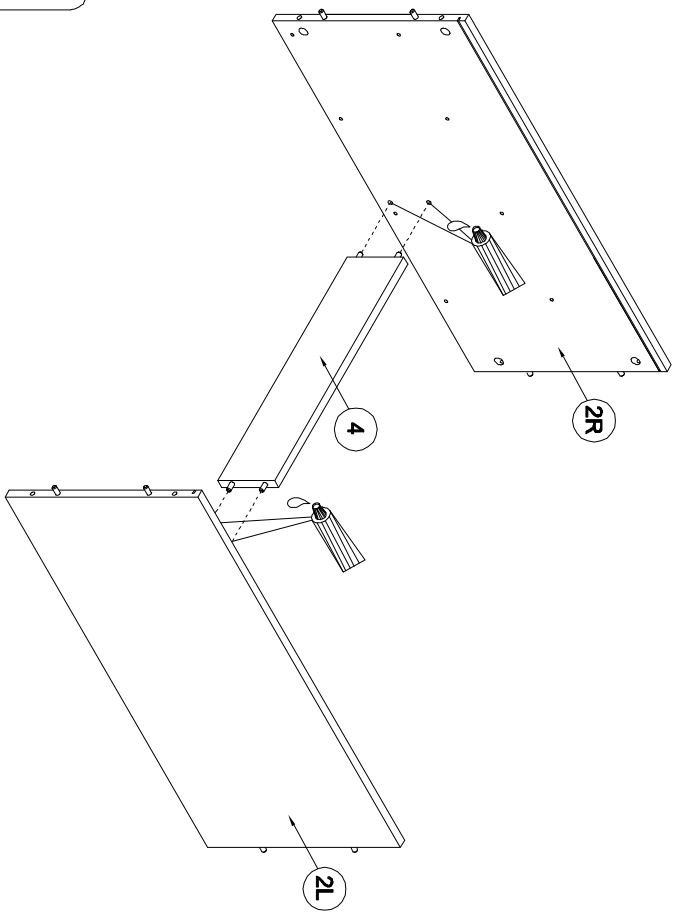

8

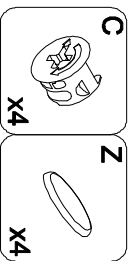
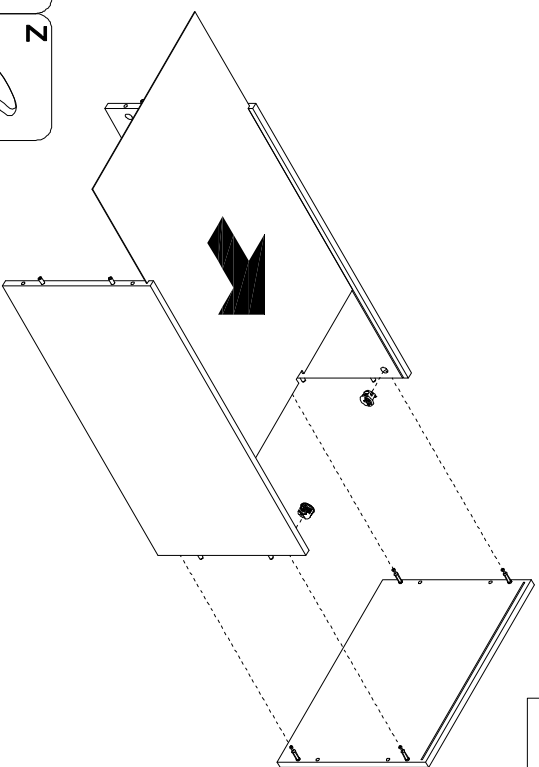
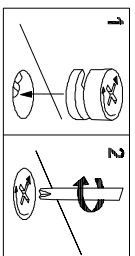

7

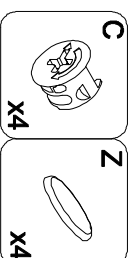
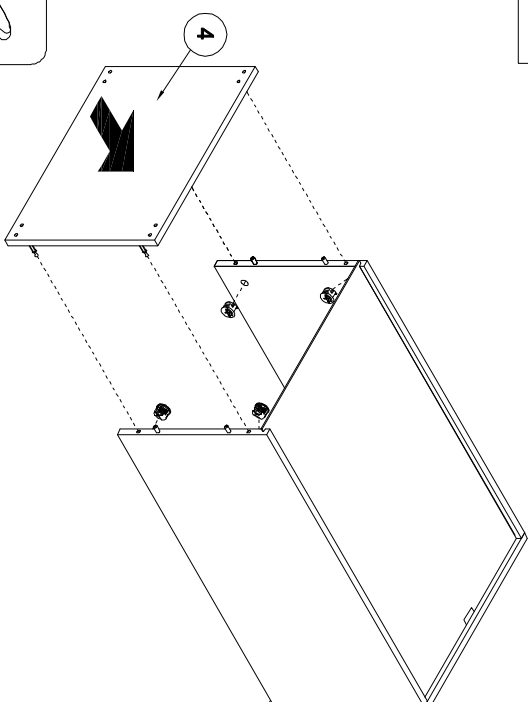
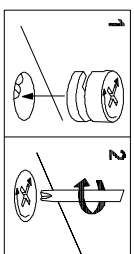

9

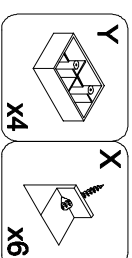
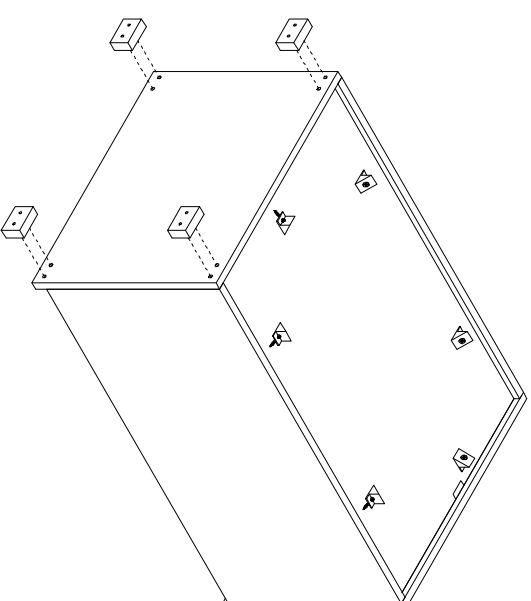

10

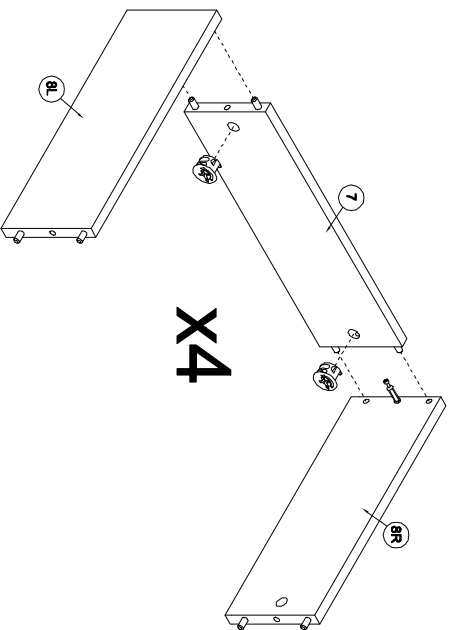
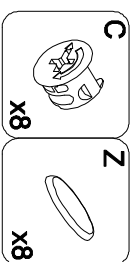
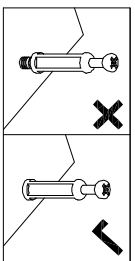
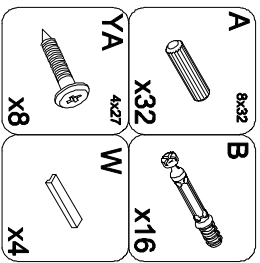
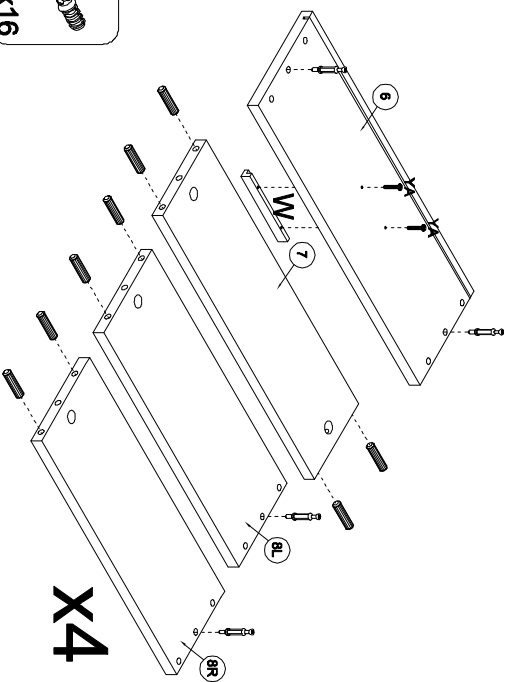

11

12

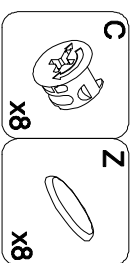
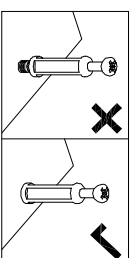
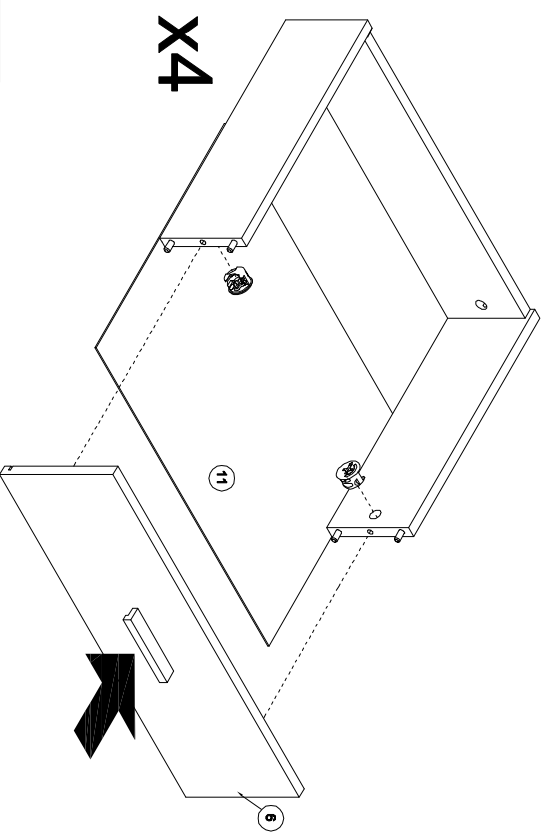

13

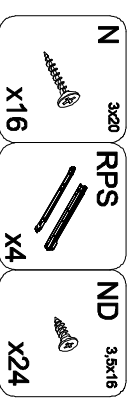
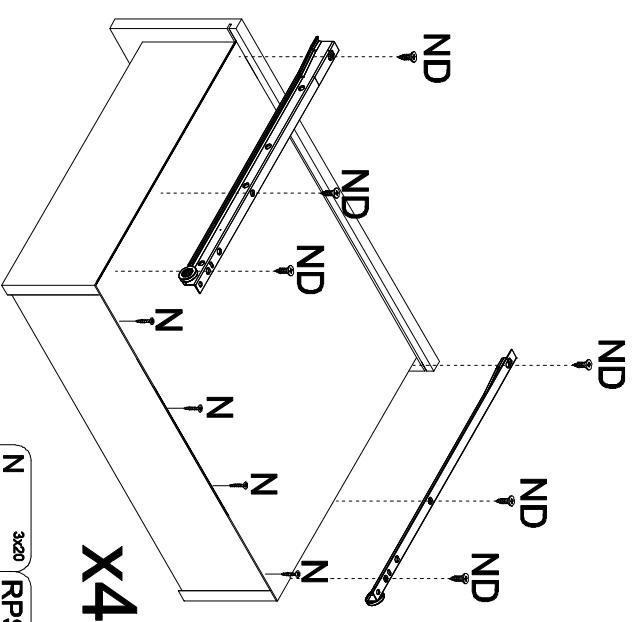

- RPS x4
- NB 3.6x13 x24
- TB x1
- TA x1
- NA 4x13 x1

